



Cable Glands

NPT Threads 2-4



PG Threads 5-13



Metric Threads..... 14-15



Accessories 16-26



Sealing Glands 27-29



Cable Entry Systems 30





Cable Glands: NPT Threads

Standard Brass Cable Glands

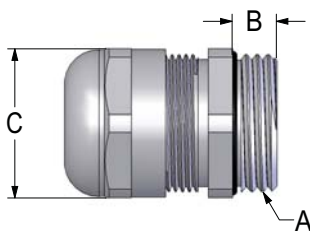

Mencom Cable Glands are easy to use and provide a good strain relief and water tight seal for round cables. The cable glands are rated up to IP 68 (comparable to NEMA 6P). The glands have a wide clamping range.

NPT style cable glands are not supplied with nuts. Nuts can be ordered separately, see page V-4.

| Brass Cable Glands | | | | | |
|--------------------|-------------------------------|---|------------------|-----------------------------------|----------------------------------|
| Part Number | Diameter Range mm (inches) | Mounting Hole Clearance mm (inches) | A Thread Type | B Thread Length mm (inches) | C Wrench Flats mm (inches) |
| MCG-3/8 | 3 - 9 (0.118 - 0.354) | 17.1 (0.675) | 3/8" NPT | 8 (0.315) | 20 (0.79) |
| MCG-1/2 | 5 - 13 (0.197 - 0.512) | 21.0 (0.825) | 1/2" NPT | 10 (0.394) | 24 (0.94) |
| MCG-3/4 | 8 - 16 (0.315 - 0.630) | 26.7 (1.050) | 3/4" NPT | 11 (0.433) | 30 (1.18) |
| MCG-1.0 | 12 - 21 (0.472 - 0.827) | 34.3 (1.350) | 1" NPT | 14 (0.551) | 40 (1.57) |
| MCG-1.25 | 16 - 27 (0.630 - 1.063) | 41.9 (1.650) | 1.25" NPT | 14 (0.551) | 50 (1.97) |
| MCG-1.5 | 21 - 35 (0.827 - 1.378) | 49.5 (1.950) | 1.5" NPT | 15 (0.591) | 55 (2.17) |
| MCG-2.0 | 27 - 48 (1.063 - 1.890) | 61.0 (2.400) | 2" NPT | 15 (0.591) | 65 (2.56) |

Materials:

Body: Nickel Plated Brass
 Insert: Polyamide
 Seal: Neoprene
 O-Ring: BUNA-N

Cable Glands: NPT Threads

Standard Plastic Cable Glands

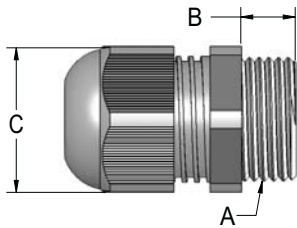

Mencom cable glands are easy to use and provide a good strain relief and water tight seal for round cables. The cable glands are rated up to IP 68-5 BAR (comparable to NEMA 6P). The glands have a wide clamping range.

NPT style cable glands are not supplied with nuts. Nuts can be ordered separately, see page V-4.

| Plastic Cable Glands | | | | | | |
|----------------------|-------------|-------------------------------|---|------------------|-----------------------------------|----------------------------------|
| Part Number | | Diameter Range mm (inches) | Mounting Hole Clearance mm (inches) | A Thread Type | B Thread Length mm (inches) | C Wrench Flats mm (inches) |
| Gray | Black | | | | | |
| PCG-3/8R | PCG-3/8R-B | 3 - 7 (0.118 - 0.276) | 17.1 (0.675) | 3/8" NPT | 15.5 (0.610) | 22 (0.87) |
| PCG-3/8 | PCG-3/8-B | 5 - 10 (0.197 - 0.394) | 17.1 (0.675) | 1/2" NPT | 15.5 (0.610) | 22 (0.87) |
| PCG-1/2X | PCG-1/2X-B | 5 - 9 (0.197 - 0.354) | 21.0 (0.825) | 1/2" NPT | 14.5 (0.571) | 24 (0.94) |
| PCG-1/2Y | PCG-1/2Y-B | 6 - 12 (0.236 - 0.472) | 21.0 (0.825) | 1/2" NPT | 14.5 (0.571) | 24 (0.94) |
| PCG-1/2R | PCG-1/2R-B | 7 - 12 (0.276 - 0.472) | 21.0 (0.825) | 1/2" NPT | 15 (0.591) | 27 (1.06) |
| PCG-1/2 | PCG-1/2-B | 10 - 14 (0.394 - 0.551) | 21.0 (0.825) | 1/2" NPT | 15 (0.591) | 27 (1.06) |
| PCG-1/2E | PCG-1/2E-B | 13 - 18 (0.512 - 0.709) | 21.0 (0.825) | 1/2" NPT | 15 (0.591) | 33 (1.30) |
| PCG-3/4R | PCG-3/4R-B | 9 - 16 (0.354 - 0.630) | 26.7 (1.050) | 3/4" NPT | 15 (0.591) | 33 (1.30) |
| PCG-3/4 | PCG-3/4-B | 14 - 18 (0.551 - 0.709) | 26.7 (1.050) | 3/4" NPT | 15 (0.591) | 33 (1.30) |
| PCG-1.0R | PCG-1.0R-B | 12 - 20 (0.472 - 0.787) | 34.3 (1.350) | 1" NPT | 18 (0.709) | 42 (1.65) |
| PCG-1.0 | PCG-1.0-B | 19 - 25 (0.748 - 0.984) | 34.3 (1.350) | 1" NPT | 18 (0.709) | 42 (1.65) |
| PCG-1.25R | PCG-1.25R-B | 20 - 26 (0.787 - 1.024) | 41.9 (1.650) | 1.25" NPT | 18 (0.709) | 53 (2.09) |
| PCG-1.25 | PCG-1.25-B | 22 - 32 (0.866 - 1.260) | 41.9 (1.650) | 1.25" NPT | 18 (0.709) | 53 (2.09) |

For the flex style version, add "S" to the part number (e.g. PCG-1/2R-BS). Flex styles are not available on the PCG-1.0 or 1.25 versions.

Materials:

Body: Polyamide

Seal: Neoprene

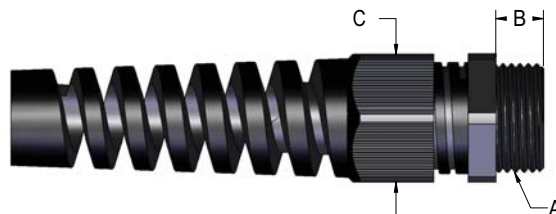

Cable Glands: NPT Threads

Nuts ❖ Plastic & Metal

| Plastic Nuts | | | | | |
|--------------|----------|-------------|------------------|------------------|--------|
| Part Number | | Thread Type | A mm (inches) | B mm (inches) | Figure |
| Gray | Black | | | | |
| 238PA | 238PA/SW | 3/8" NPT | 22 (0.87) | 5 (0.20) | 1 |
| 212PA | 212PA/SW | 1/2" NPT | 27 (1.06) | 6 (0.24) | 1 |
| 234PA | 234PA/SW | 3/4" NPT | 36 (1.42) | 7 (0.28) | 1 |
| 210PA | 210PA/SW | 1" NPT | 42 (1.65) | 7 (0.28) | 1 |

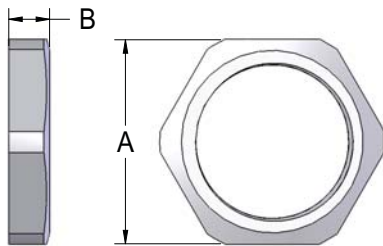

Figure 1

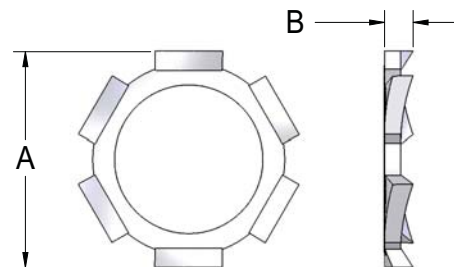
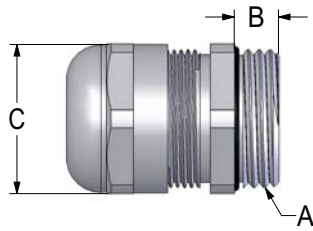

Figure 2

| Metal Nuts | | | | |
|----------------------------|-------------|------------------|------------------|--------|
| Part Number | Thread Type | A mm (inches) | B mm (inches) | Figure |
| 214M | 1/4" NPT | 17.5 (0.69) | 3.3 (0.13) | 1 |
| 238M | 3/8" NPT | 20.1 (0.79) | 3.0 (0.12) | 1 |
| 212M | 1/2" NPT | 28.4 (1.12) | 3.3 (0.13) | 2 |
| 234M | 3/4" NPT | 35.1 (1.38) | 3.8 (0.15) | 2 |
| 210M | 1" NPT | 42.9 (1.69) | 5.1 (0.20) | 2 |
| Material: Steel Zinc Plate | | | | |

Cable Glands: PG Threads

Standard Brass Cable Glands



Mencom cable glands are easy to use and provide a good strain relief and water tight seal for round cables. The cable glands are rated up to IP 68 (comparable to NEMA 6P). The glands have a wide clamping range.

An O-Ring and Locking Nut are supplied on all PG threaded metal cable glands.

| Part Number | Diameter Range mm (inches) | Mounting Hole Clearance (inches) | A Thread Type | B Thread Length mm (inches) | C Wrench Flats mm (inches) |
|-------------|-------------------------------|-------------------------------------|------------------|-----------------------------------|----------------------------------|
| MCG-07R | 2 - 5 (0.079 - 0.196) | 12.7 (.500) | PG 7 | 5 (.197) | 14 (.551) |
| MCG-07 | 3 - 6.5 (.118-.255) | 12.7 (.500) | PG 7 | 5 (.197) | 14 (.551) |
| MCG-09R | 2 - 6 (0.079-.236) | 15.4 (.606) | PG 9 | 6 (.236) | 17 (.669) |
| MCG-09 | 4 - 8 (.157-.315) | 15.4 (.606) | PG 9 | 6 (.236) | 17 (.669) |
| MCG-11R | 3 - 7 (.118-.275) | 18.8 (.740) | PG 11 | 6 (.236) | 20 (.787) |
| MCG-11 | 5 - 10 (.197-.393) | 18.8 (.740) | PG 11 | 6 (.236) | 20 (.787) |
| MCG-13.5R | 5 - 9 (.197-.354) | 20.7 (.815) | PG 13.5 | 6.5 (.256) | 22 (.866) |
| MCG-13.5 | 6 - 12 (.236-.472) | 20.7 (.815) | PG 13.5 | 6.5 (.256) | 22 (.866) |
| MCG-16R | 7 - 12 (.276-.472) | 22.8 (.900) | PG 16 | 6.5 (.256) | 24 (.945) |
| MCG-16 | 10 - 14 (.394-.551) | 22.8 (.900) | PG 16 | 6.5 (.256) | 24 (.945) |
| MCG-21R | 9 - 16 (.354-.630) | 28.6 (1.125) | PG 21 | 7 (.276) | 30 (1.181) |
| MCG-21 | 13 - 18 (.512-.708) | 28.6 (1.125) | PG 21 | 7 (.276) | 30 (1.181) |
| MCG-29R | 12 - 20 (.472-.787) | 37.4 (1.475) | PG 29 | 8 (.315) | 40 (1.575) |
| MCG-29 | 18 - 25 (.709-.984) | 37.4 (1.475) | PG 29 | 8 (.315) | 40 (1.575) |
| MCG-36R | 20 - 26 (.787-1.02) | 47.5 (1.870) | PG 36 | 9 (.354) | 50 (1.968) |
| MCG-36 | 24 - 32 (.866-1.26) | 47.5 (1.870) | PG 36 | 9 (.354) | 50 (1.968) |
| MCG-42R | 25 - 31 (.984-1.22) | 54.5 (2.145) | PG 42 | 10 (.394) | 57 (2.244) |
| MCG-42 | 30 - 38 (1.18-1.50) | 54.5 (2.145) | PG 42 | 10 (.394) | 57 (2.244) |
| MCG-48R | 29 - 35 (1.14-1.38) | 59.8 (2.354) | PG 48 | 10 (.394) | 64 (2.520) |
| MCG-48 | 34 - 44 (1.34-1.73) | 59.8 (2.354) | PG 48 | 10 (.394) | 64 (2.520) |

Longer thread length (0.590") is available, add "L" to the end of the part number (e.g. MCG-21L).

Materials:

Body: Nickel Plated Brass
 Insert: Polyamide
 Seal: Neoprene



Cable Glands: PG Threads

Standard Plastic Cable Glands

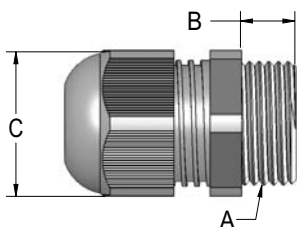

Mencom Cable Glands are easy to use and provide a good strain relief and water tight seal for round cables. The cable glands are rated up to IP 68-5 Bar (comparable to NEMA 6P). The glands have a wide clamping range.

A Locking Nut is supplied on all PG threaded parts. O-Rings are not required to maintain a seal on sizes PG 7 to PG 21, but are supplied on size PG 29 and larger.

| Part Number | | Diameter Range mm (inches) | Mounting Hole Clearance mm (inches) | A Thread Type | B Thread Length mm (inches) | C Wrench Flats mm (inches) |
|-------------|-------------|-------------------------------|---|------------------|-----------------------------------|----------------------------------|
| Gray | Black | | | | | |
| PCG-07R | PCG-07-B | 2 - 5 (.079-.196) | 12.7 (.500) | PG 7 | 8 (.315) | 15 (.591) |
| PCG-07 | PCG-07-B | 3 - 6.5 (.118-.255) | 12.7 (.500) | PG 7 | 8 (.315) | 15 (.591) |
| PCG-09R | PCG-09R-B | 2 - 6 (.079-.236) | 15.4 (.606) | PG 9 | 8 (.315) | 19 (.748) |
| PCG-09 | PCG-09-B | 4 - 8 (.157-.315) | 15.4 (.606) | PG 9 | 8 (.315) | 19 (.748) |
| PCG-11R | PCG-11R-B | 3 - 7 (.118-.275) | 18.8 (.740) | PG 11 | 8 (.315) | 22 (.866) |
| PCG-11 | PCG-11-B | 5 - 10 (.197-.393) | 18.8 (.740) | PG 11 | 8 (.315) | 22 (.866) |
| PCG-13.5R | PCG-13.5R-B | 5 - 9 (.197-.354) | 20.7 (.815) | PG 13.5 | 9 (.354) | 24 (.945) |
| PCG-13.5 | PCG-13.5-B | 6 - 12 (.236-.472) | 20.7 (.815) | PG 13.5 | 9 (.354) | 24 (.945) |
| PCG-16R | PCG-16R-B | 7 - 12 (.276-.472) | 22.8 (.900) | PG 16 | 10 (.394) | 27 (1.06) |
| PCG-16 | PCG-16-B | 10 - 14 (.394-.551) | 22.8 (.900) | PG 16 | 10 (.394) | 27 (1.06) |
| PCG-21R | PCG-21R-B | 9 - 16 (.354-.630) | 28.6 (1.125) | PG 21 | 11 (.433) | 33 (1.30) |
| PCG-21 | PCG-21-B | 13 - 18 (.512-.708) | 28.6 (1.125) | PG 21 | 11 (.433) | 33 (1.30) |
| PCG-29R | PCG-29R-B | 12 - 20 (.472-.787) | 37.4 (1.475) | PG 29 | 11 (.433) | 42 (1.65) |
| PCG-29 | PCG-29-B | 18 - 25 (.709-.984) | 37.4 (1.475) | PG 29 | 11 (.433) | 42 (1.65) |
| PCG-36R | PCG-36R-B | 20 - 26 (.787-1.02) | 47.5 (1.870) | PG 36 | 13 (.512) | 53 (2.09) |
| PCG-36 | PCG-36-B | 22 - 32 (.866-1.26) | 47.5 (1.870) | PG 36 | 13 (.512) | 53 (2.09) |
| PCG-42R | PCG-42R-B | 25 - 31 (.984-1.22) | 54.5 (2.145) | PG 42 | 13 (.512) | 60 (2.36) |
| PCG-42 | PCG-42-B | 30 - 38 (1.18-1.50) | 54.5 (2.145) | PG 42 | 13 (.512) | 60 (2.36) |
| PCG-48R | PCG-48R-B | 29 - 35 (1.14-1.38) | 59.8 (2.354) | PG 48 | 14 (.552) | 65 (2.60) |
| PCG-48 | PCG-48-B | 34 - 44 (1.34-1.73) | 59.8 (2.354) | PG 48 | 14 (.552) | 65 (2.60) |

For the Flex Style Version, add "S" to the part number (e.g. PCG-16R-BS).

Flex Styles are not available on the PCG-29 to PCG-48 versions.

Materials:

Body: Polyamide
Seal: Neoprene

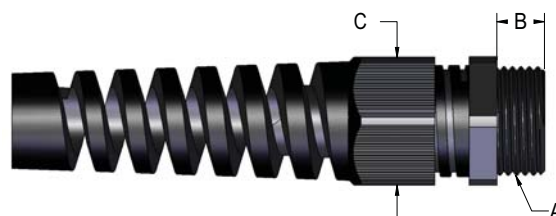

Cable Glands: PG Threads

EMI Shielding Brass Cable Glands

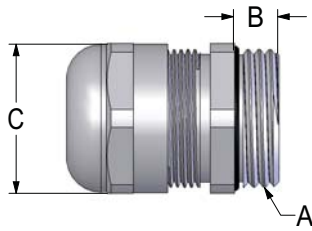

Mencom EMI Cable Glands provide an easy way to ground the shield from a shielded cable to the body of the metal cable gland. The seal rating is IP 68.

A special cutting Locking Nut and O-Ring are supplied on EMI Shielding Cable Glands. The nut will cut through painted surfaces to allow the gland to ground to the metal panel.

| Part Number | Diameter Range mm (inches) | Mounting Hole Clearance mm (inches) | A Thread Type | B Thread Length mm (inches) | C Wrench Flats mm (inches) |
|-------------|-------------------------------|--|------------------|-----------------------------------|----------------------------------|
| MCGB-07R | 2 - 5 (.079-.196) | 12.7 (.500) | PG 7 | 5 (.197) | 14 (.551) |
| MCGB-07 | 3 - 6.5 (.118-.255) | 12.7 (.500) | PG 7 | 5 (.197) | 14 (.551) |
| MCGB-09R | 2 - 6 (.079-.236) | 15.4 (.606) | PG 9 | 6 (.236) | 17 (.669) |
| MCGB-09 | 4 - 8 (.157-.315) | 15.4 (.606) | PG 9 | 6 (.236) | 17 (.669) |
| MCGB-11R | 3 - 7 (.118-.275) | 18.8 (.740) | PG 11 | 6 (.236) | 20 (.787) |
| MCGB-11 | 5 - 10 (.197-.393) | 18.8 (.740) | PG 11 | 6 (.236) | 20 (.787) |
| MCGB-13.5R | 5 - 9 (.197-.354) | 20.7 (.815) | PG 13.5 | 6.5 (.256) | 22 (.866) |
| MCGB-13.5 | 6 - 12 (.236-.472) | 20.7 (.815) | PG 13.5 | 6.5 (.256) | 22 (.866) |
| MCGB-16R | 7 - 12 (.276-.472) | 22.8 (.900) | PG 16 | 6.5 (.256) | 24 (.945) |
| MCGB-16 | 10 - 14 (.394-.551) | 22.8 (.900) | PG 16 | 6.5 (.256) | 24 (.945) |
| MCGB-21R | 9 - 16 (.354-.630) | 28.6 (1.125) | PG 21 | 7 (.276) | 30 (1.181) |
| MCGB-21 | 13 - 18 (.512-.708) | 28.6 (1.125) | PG 21 | 7 (.276) | 30 (1.181) |
| MCGB-29R | 12 - 20 (.472-.787) | 37.4 (1.475) | PG 29 | 8 (.315) | 40 (1.575) |
| MCGB-29 | 18 - 25 (.709-.984) | 37.4 (1.475) | PG 29 | 8 (.315) | 40 (1.575) |
| MCGB-36R | 20 - 26 (.787-1.02) | 47.5 (1.870) | PG 36 | 9 (.354) | 50 (1.968) |
| MCGB-36 | 24 - 32 (.866-1.26) | 47.5 (1.870) | PG 36 | 9 (.354) | 50 (1.968) |
| MCGB-42R | 25 - 31 (.984-1.22) | 54.5 (2.145) | PG 42 | 10 (.394) | 57 (2.244) |
| MCGB-42 | 30 - 38 (1.18-1.50) | 54.5 (2.145) | PG 42 | 10 (.394) | 57 (2.244) |
| MCGB-48R | 29 - 35 (1.14-1.38) | 59.8 (2.354) | PG 48 | 10 (.394) | 64 (2.520) |
| MCGB-48 | 34 - 44 (1.34-1.73) | 59.8 (2.354) | PG 48 | 10 (.394) | 64 (2.520) |

Materials:

Body: Nickel Plated Brass
 Insert: Polyamide
 Seal: Neoprene





Cable Glands: PG Threads

Clamping Cable Glands

CRSS Series

Nickel Plated Brass Cable Gland with self-centering double saddle clamps. The seal is achieved with a neoprene sealing ring (with multiple perforations to accommodate a wide range of diameters). Brass Nuts and O-Rings for these must be ordered separately. Protection to IP 55.



| CRSS Series | | |
|-------------|----------------------------|-------------|
| Part Number | Diameter Range mm (inches) | Thread Type |
| CRSS-09 | 7 - 10 (0.255 - 0.374) | PG 9 |
| CRSS-11 | 8 - 12 (0.295 - 0.452) | PG 11 |
| CRSS-13.5 | 9 - 13 (0.334 - 0.531) | PG 13.5 |
| CRSS-16 | 10 - 15 (0.374 - 0.591) | PG 16 |
| CRSS-21 | 12.5 - 19 (0.472 - 0.748) | PG 21 |
| CRSS-29 | 19 - 27 (0.728 - 1.063) | PG 29 |
| CRSS-36 | 26 - 33 (1.00 - 1.30) | PG 36 |
| CRSS-42 | 30.5 - 39 (1.18 - 1.54) | PG 42 |
| CRSS-48 | 35 - 45 (1.35 - 1.77) | PG 48 |

CRT Series

Nickel Plated Brass Cable Gland with multiple perforations. The seal is made of nitrile rubber, per DIN 46320.



| CRT Series | | |
|-------------|----------------------------|-------------|
| Part Number | Diameter Range mm (inches) | Thread Type |
| CRT-09 | 4 - 11 (0.157 - 0.433) | PG 9 |
| CRT-11 | 6 - 12 (0.236 - 0.472) | PG 11 |
| CRT-13.5 | 6 - 13 (0.236 - 0.512) | PG 13.5 |
| CRT-16 | 6 - 16 (0.236 - 0.630) | PG 16 |
| CRT-21 | 9 - 20 (0.354 - 0.787) | PG 21 |
| CRT-29 | 17 - 28 (0.669 - 1.102) | PG 29 |
| CRT-36 | 23 - 34 (0.906 - 1.339) | PG 36 |
| CRT-42 | 29 - 40 (1.142 - 1.575) | PG 42 |
| CRT-48 | 35 - 47 (1.378 - 1.850) | PG 48 |

Cable Glands: PG Threads

Plastic Right Angle Cable Glands

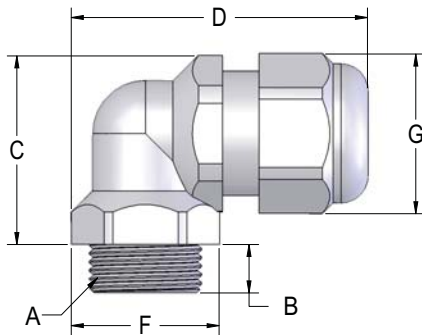

Mencom Cable Glands are easy to use and provide a good strain relief and water tight seal for round cables. The cable glands are rated up to IP 68-5 Bar (comparable to NEMA 6P). The glands have a wide clamping range.

A Locking Nut is supplied on all PG threaded parts.

| Part Number | Diameter Range mm (inches) | Mounting Hole Clearance mm (inches) | A Thread Type | B Thread Length mm (inches) | C Height mm (inches) | D Length mm (inches) | F Wrench Flats mm (inches) | G Wrench Flats mm (inches) |
|-------------|-------------------------------|---|---------------------|-----------------------------------|----------------------------|----------------------------|----------------------------------|----------------------------------|
| PCGA-07R | 2 - 6 (0.079- 0.236) | 12.7 (0.500) | PG 7 | 8 (0.315) | 26 (1.02) | 38.5 (1.516) | 15 (0.591) | 19 (0.748) |
| PCGA-07 | 4 - 8 (0.157- 0.315) | 12.7 (0.500) | PG 7 | 8 (0.315) | 26 (1.02) | 38.5 (1.516) | 15 (0.591) | 19 (0.748) |
| PCGA-09R | 3 - 7 (0.118- 0.276) | 15.4 (0.606) | PG 9 | 8 (0.315) | 29 (1.14) | 47 (1.850) | 19 (0.748) | 22 (0.866) |
| PCGA-09 | 5 - 10 (0.197- 0.394) | 15.4 (0.606) | PG 9 | 8 (0.315) | 29 (1.14) | 47 (1.850) | 19 (0.748) | 22 (0.866) |
| PCGA-11R | 5 - 7 (0.197- 0.276) | 18.8 (0.740) | PG 11 | 8 (0.315) | 31.3 (1.23) | 51 (2.008) | 22 (0.866) | 24 (0.945) |
| PCGA-11 | 6 - 12 (0.236- 0.472) | 18.8 (0.740) | PG 11 | 8 (0.315) | 31.3 (1.23) | 51 (2.008) | 22 (0.866) | 24 (0.945) |
| PCGA-13.5R | 7 - 12 (0.276- 0.472) | 20.7 (0.815) | PG 13.5 | 9 (0.354) | 34 (1.34) | 54.7 (2.154) | 24 (0.945) | 27 (1.063) |
| PCGA-13.5 | 10 - 14 (0.394- 0.551) | 20.7 (0.815) | PG 13.5 | 9 (0.354) | 34 (1.34) | 54.7 (2.154) | 24 (0.945) | 27 (1.063) |
| PCGA-16 | 11 - 17 (0.433- 0.669) | 22.8 (0.900) | PG 16 | 10 (0.394) | 38.2 (1.50) | 57 (2.241) | 27 (1.063) | 29 (1.142) |
| PCGA-21 | 15 - 21 (0.591- 0.827) | 28.6 (1.125) | PG 21 | 11 (0.433) | 45.7 (1.80) | 71 (2.795) | 33 (1.299) | 36 (1.417) |
| PCGA-29 | 21 - 28 (0.827- 1.102) | 37.4 (1.475) | PG 29 | 11 (0.433) | 57 (2.24) | 85 (3.346) | 42 (1.654) | 46 (1.811) |

Standard color is gray. For black, add "-B" to the end of the part number (e.g. PCGA-09R-B).

Materials:

Body: Polyamide
Seal: Neoprene



Cable Glands: PG Threads

Adapters

| PG to NPT Adapter | | | | | | |
|-------------------|---------------|---------------|-----------|-----------|-----------|-----------|
| Part Number | A External | B Internal | C (mm) | D (mm) | E (mm) | F (mm) |
| PG11-3/8 | PG 11 | 3/8" NPT | 14 | 6.0 | 13.5 | 20 |
| PG11-1/2 | PG 11 | 1/2" NPT | 18 | 6.5 | 13 | 24 |
| PG13.5-1/2 | PG 13.5 | 1/2" NPT | 18 | 6.5 | 17 | 24 |
| PG16-1/2 | PG 16 | 1/2" NPT | 18 | 6.5 | 17 | 24 |
| PG21-3/4 | PG 21 | 3/4" NPT | 18 | 7.0 | 22 | 30 |
| PG29-1 | PG 29 | 1.0" NPT | 18 | 8.0 | 29 | 39 |
| PG36-1.25 | PG 36 | 1.25" NPT | 20 | 9.0 | 36 | 50 |
| PG42-1.5 | PG 42 | 1.5" NPT | 18 | 10 | 42.7 | 57 |

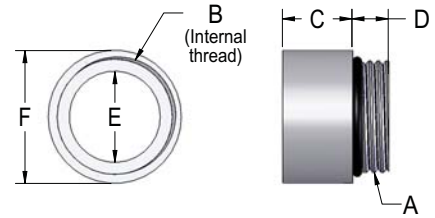

Materials:

Body: Nickel Plated Brass
O-Ring: BUNA-N

| PG to Metric Adapter | | | | | | |
|----------------------|---------------|---------------|-----------|-----------|-----------|-----------|
| Part Number | A External | B Internal | C (mm) | D (mm) | E (mm) | F (mm) |
| PG07-M12 | PG 07 | M12 x 1.5 | 14 | 5 | 15 | 9 |
| PG09-M16 | PG 09 | M16 x 1.5 | 19 | 6 | 16 | 12.2 |
| PG11-M16 | PG 11 | M16 x 1.5 | 22 | 6 | 16 | 13 |
| PG13.5-M20 | PG 13.5 | M20 x 1.5 | 24 | 6.5 | 17.5 | 16 |
| PG16-M20 | PG 16 | M20 x 1.5 | 27 | 6.5 | 17.5 | 18.5 |
| PG16-M25 | PG 16 | M25 x 1.5 | 30 | 6.5 | 18.5 | 18.5 |
| PG21-M25 | PG 21 | M25 x 1.5 | 32 | 7 | 19 | 23 |
| PG21-M32 | PG 21 | M32 x 1.5 | 36 | 7 | 20 | 23 |
| PG29-M40 | PG 29 | M40 x 1.5 | 43 | 8 | 21 | 32 |
| PG36-M50 | PG 36 | M50 x 1.5 | 55 | 9 | 23 | 42 |
| PG42-M63 | PG 42 | M63 x 1.5 | 65 | 10 | 25 | 48 |

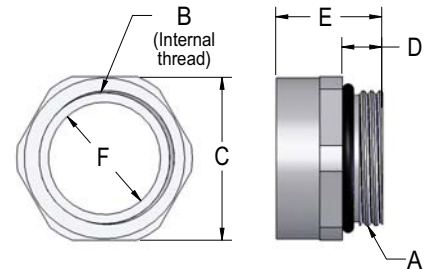

Materials:

Body: Nickel Plated Brass
O-Ring: BUNA-N

Cable Glands & Adapters

Cable Glands: PG Threads

Nuts ❖ Plastic & Metal

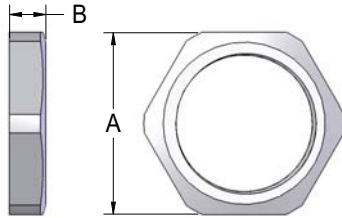

Material:
Polyamide

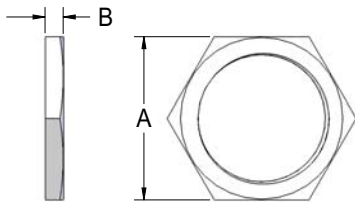

Standard Metal Nut

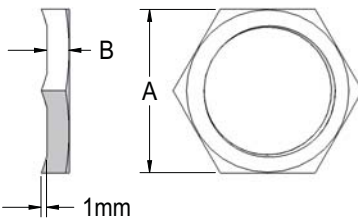

Cutting Metal Nut

| Plastic Nuts | | | | |
|--------------|----------|--------|--------|-------------|
| Part Number | | A (mm) | B (mm) | Thread Type |
| Gray | Black | | | |
| 207PA | 207PA/SW | 19 | 5 | PG 7 |
| 209PA | 209PA/SW | 22 | 5 | PG 9 |
| 211PA | 211PA/SW | 24 | 5 | PG 11 |
| 213PA | 213PA/SW | 27 | 6 | PG 13.5 |
| 216PA | 216PA/SW | 30 | 6 | PG 16 |
| 221PA | 221PA/SW | 36 | 7 | PG 21 |
| 229PA | 229PA/SW | 46 | 7 | PG 29 |
| 236PA | 236PA/SW | 60 | 8 | PG 36 |
| 242PA | 242PA/SW | 65 | 8 | PG 42 |
| 248PA | 248PA/SW | 70 | 8 | PG 48 |

| Metal Nuts | | | | |
|-------------|---------|--------|--------|-------------|
| Part Number | | A (mm) | B (mm) | Thread Type |
| Standard | Cutting | | | |
| 207M | 207MPOT | 15 | 2.8 | PG 7 |
| 209M | 209MPOT | 18 | 2.8 | PG 9 |
| 211M | 211MPOT | 21 | 3 | PG 11 |
| 213M | 213MPOT | 23 | 3 | PG 13.5 |
| 216M | 216MPOT | 26 | 3 | PG 16 |
| 221M | 221MPOT | 32 | 3.5 | PG 21 |
| 229M | 229MPOT | 41 | 4 | PG 29 |
| 236M | 236MPOT | 51 | 5 | PG 36 |
| 242M | 242MPOT | 65 | 5 | PG 42 |
| 248M | 248MPOT | 69 | 5.5 | PG 48 |

Material:
Nickel Plated Brass



Cable Glands: PG Threads

Blanking Plugs ❖ Blind Plugs

| Blanking Plugs | | | | | | | |
|----------------|---------------|----------|---------------|--------------------|---------------|--------------------|-------------|
| Part Number | | | Plastic | | Metal | | Thread Type |
| Gray Plastic | Black Plastic | Metal | Diameter (mm) | Thread Length (mm) | Diameter (mm) | Thread Length (mm) | |
| CRB-07PA | CRB-07PA/SW | CRB-07 | 15 | 6 | 16 | 4.5 | PG 07 |
| CRB-09PA | CRB-09PA/SW | CRB-09 | 19 | 6 | 19 | 4.5 | PG 09 |
| CRB-11PA | CRB-11PA/SW | CRB-11 | 22 | 6 | 22 | 4.5 | PG 11 |
| CRB-13.5PA | CRB-13.5PA/SW | CRB-13.5 | 25 | 6 | 24 | 6.0 | PG 13.5 |
| CRB-16PA | CRB-16PA/SW | CRB-16 | 27 | 6 | 26 | 6.0 | PG 16 |
| CRB-21PA | CRB-21PA/SW | CRB-21 | 33 | 8 | 32 | 6.0 | PG 21 |
| CRB-29PA | CRB-29PA/SW | CRB-29 | 44.5 | 8 | 39 | 8.0 | PG 29 |
| CRB-36PA | CRB-36PA/SW | CRB-36 | 55.5 | 10 | 50 | 9.0 | PG 36 |
| CRB-42PA | CRB-42PA/SW | CRB-42 | 62.5 | 10 | 57 | 10.0 | PG 42 |
| CRB-48PA | CRB-48PA/SW | CRB-48 | 69.5 | 12 | 64 | 10.0 | PG 48 |

Materials:

Metal: Nickel Plated Brass

Plastic: Polystyrene

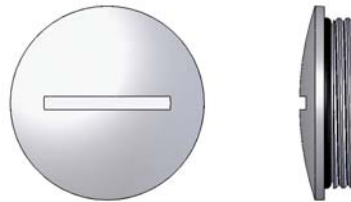

Blind Plugs

This insert is used to block a PCG or MCG style cable gland that is not currently in use, but is installed onto a panel. The Blind Plug will enable the cable gland to seal to IP 68. The Blind Plug is NOT for use in the EX style cable glands.

| Blind Plugs | | | | | | |
|-------------|-------------|----|------|-----|-----|----|
| Part Number | Thread Type | L | H | D1 | D2 | D3 |
| PG07-BP | PG 07 | 6 | 14 | 8.5 | 6.5 | 5 |
| PG09-BP | PG 09 | 7 | 16 | 10 | 8 | 6 |
| PG11-BP | PG 11 | 8 | 18 | 12 | 10 | 7 |
| PG13.5-BP | PG 13.5 | 9 | 20 | 14 | 12 | 9 |
| PG16-BP | PG 16 | 10 | 22.5 | 16 | 14 | 12 |
| PG21-BP | PG 21 | 12 | 26.5 | 20 | 18 | 16 |
| PG29-BP | PG 29 | 14 | 30.5 | 28 | 25 | 20 |

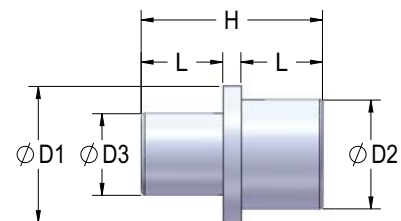

Material:

Polyamide

Cable Glands: PG Threads

Reducers & Enlargers



| PG Reducers | | | | | |
|-------------|---------|---------|--------|--------|--------|
| Part Number | A | B | C (mm) | D (mm) | E (mm) |
| CEC-07 | PG 09 | PG 07 | 18 | 2.5 | 6 |
| CEC-07X | PG 11 | PG 07 | 20 | 2.5 | 6 |
| CEC-07Y | PG 13.5 | PG 07 | 24 | 3 | 6.5 |
| CEC-07Z | PG 16 | PG 07 | 24 | 3 | 6.5 |
| CEC-09 | PG 11 | PG 09 | 20 | 2.5 | 6 |
| CEC-09X | PG 13.5 | PG 09 | 24 | 3 | 6.5 |
| CEC-09Y | PG 16 | PG 09 | 24 | 3 | 6.5 |
| CEC-11 | PG 13.5 | PG 11 | 24 | 3 | 6.5 |
| CEC-11X | PG 16 | PG 11 | 24 | 3 | 6.5 |
| CEC-13.5 | PG 16 | PG 13.5 | 24 | 3 | 6.5 |
| CEC-13.5X | PG 21 | PG 13.5 | 32 | 3 | 7 |
| CEC-16 | PG 21 | PG 16 | 32 | 3 | 7 |
| CEC-16X | PG 29 | PG 16 | 41 | 3.5 | 8 |
| CEC-21 | PG 29 | PG 21 | 41 | 3.5 | 8 |
| CEC-29 | PG 36 | PG 29 | 50 | 3.5 | 9 |

| PG Enlargers | | | | | | |
|--------------|---------|---------|--------|--------|--------|--------|
| Part Number | A | B | C (mm) | D (mm) | E (mm) | F (mm) |
| CRC-07 | PG 07 | PG 09 | 10 | 5 | 10 | 17 |
| CRC-09 | PG 09 | PG 11 | 10.5 | 6 | 12 | 20 |
| CRC-09X | PG 09 | PG 13.5 | 11.5 | 6 | 12 | 22 |
| CRC-11 | PG 11 | PG 13.5 | 11.5 | 6 | 15 | 22 |
| CRC-11X | PG 11 | PG 16 | 12.5 | 6.5 | 15 | 24 |
| CRC-13.5 | PG 13.5 | PG 16 | 12.5 | 6.5 | 17 | 24 |
| CRC-16 | PG 16 | PG 21 | 14.5 | 6.5 | 18.5 | 30 |
| CRC-16X | PG 16 | PG 29 | 16 | 6.5 | 18.5 | 39 |
| CRC-21 | PG 21 | PG 29 | 16 | 7 | 24 | 39 |
| CRC-29 | PG 29 | PG 36 | 19.5 | 8 | 32 | 50 |
| CRC-36 | PG 36 | PG 42 | 22 | 9 | 42 | 57 |

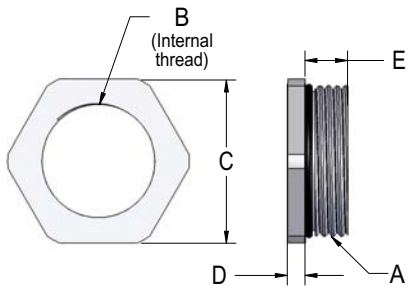

Materials:

Body: Nickel Plated Brass
O-Ring: BUNA-N

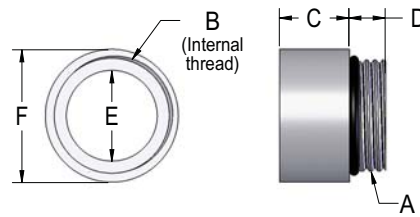

Materials:

Body: Nickel Plated Brass
O-Ring: BUNA-N



Cable Glands: Metric Threads

Standard Brass Cable Glands

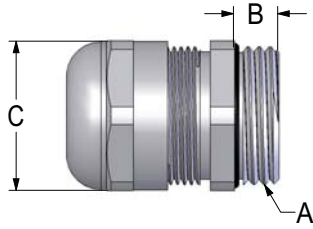

Mencom Cable Glands are easy to use and provide a good strain relief and water tight seal for round cables. The cable glands are rated up to IP 68 (comparable to NEMA 6P). The glands have a wide clamping range.

A Locking Nut and an O-Ring are supplied on all Metric threaded Metal Cable Glands, except where noted.

| Part Number | Diameter Range (mm) | A Mounting Hole Clearance (mm) | B Thread Length (mm) | C Wrench Flats (mm) | Thread Type |
|-------------|---------------------|--------------------------------|----------------------|---------------------|-------------|
| MCG-M06* | 2 - 3.2 | 6.5 | 6 | 8 | M 6 x 1.0 |
| MCG-M08* | 3 - 5 | 8.5 | 4 | 11 | M 8 x 1.25 |
| MCG-M12 | 3 - 6 | 12.5 | 5 | 14 | M12 x 1.5 |
| MCG-M16 | 3 - 9 | 16.5 | 5 | 17 | M16 x 1.5 |
| MCG-M20 | 5 - 13 | 20.5 | 6 | 22 | M20 x 1.5 |
| MCG-M25 | 8 - 16 | 25.5 | 7 | 27 | M25 x 1.5 |
| MCG-M32 | 12 - 21 | 32.5 | 8 | 34 | M32 x 1.5 |
| MCG-M40 | 16 - 27 | 40.5 | 8 | 43 | M40 x 1.5 |
| MCG-M50 | 21 - 35 | 50.5 | 9 | 55 | M50 x 1.5 |
| MCG-M63 | 27 - 48 | 63.5 | 10 | 65 | M63 x 1.5 |

* MCG-M06 & MCG-M08 are not supplied with Locking Nuts. Nuts are not available for these cable glands.

Material:

Body: Nickel Plated Brass
 Insert: Polyamide
 Seal: Neoprene
 O-Ring: BUNA-N

Cable Glands: Metric Threads

Standard Plastic Cable Glands

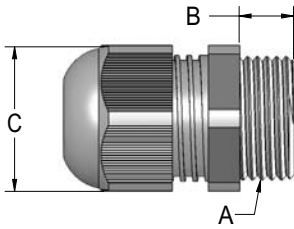

Mencom Cable Glands are easy to use and provide a good strain relief and water tight seal for round cables. The cable glands are rated up to IP 68-5 Bar (comparable to NEMA 6P). The glands have a wide clamping range.

A Locking Nut is supplied on all Metric threaded parts. O-Rings are not required to maintain a seal on any sizes smaller than M32. An O-Ring is supplied on size M32 and larger.

| Part Number | | Diameter Range (mm) | A Mounting Hole Clearance (mm) | B Thread Length (mm) | C Wrench Flats (mm) | Thread Type |
|-------------|------------|---------------------|--------------------------------------|----------------------------|---------------------------|-------------|
| Gray | Black | | | | | |
| PCG-M12R | PCG-M12R-B | 2 - 5 | 12.5 | 8 | 15 | M12 x 1.5 |
| PCG-M12 | PCG-M12-B | 3 - 6.5 | 12.5 | 8 | 15 | M12 x 1.5 |
| PCG-M16R | PCG-M16R-B | 3 - 7 | 16.5 | 8 | 22 | M16 x 1.5 |
| PCG-M16 | PCG-M16-B | 5 - 10 | 16.5 | 8 | 22 | M16 x 1.5 |
| PCG-M20R | PCG-M20R-B | 5 - 9 | 20.5 | 8 | 24 | M20 x 1.5 |
| PCG-M20 | PCG-M20-B | 10 - 14 | 20.5 | 8 | 27 | M20 x 1.5 |
| PCG-M25R | PCG-M25R-B | 9 - 16 | 25.5 | 8 | 33 | M25 x 1.5 |
| PCG-M25 | PCG-M25-B | 13 - 18 | 25.5 | 8 | 33 | M25 x 1.5 |
| PCG-M32R | PCG-M32R-B | 12 - 20 | 32.5 | 10 | 42 | M32 x 1.5 |
| PCG-M32 | PCG-M32-B | 18 - 25 | 32.5 | 10 | 42 | M32 x 1.5 |
| PCG-M40R | PCG-M40R-B | 20 - 26 | 40.5 | 10 | 53 | M40 x 1.5 |
| PCG-M40 | PCG-M40-B | 22 - 32 | 40.5 | 10 | 53 | M40 x 1.5 |
| PCG-M50R | PCG-M50R-B | 25 - 31 | 50.5 | 12 | 60 | M50 x 1.5 |
| PCG-M50 | PCG-M50-B | 30 - 38 | 50.5 | 12 | 60 | M50 x 1.5 |
| PCG-M63R | PCG-M63R-B | 29 - 35 | 63.5 | 12 | 65 | M63 x 1.5 |
| PCG-M63 | PCG-M63-B | 34 - 44 | 63.5 | 12 | 65 | M63 x 1.5 |

For the Flex Style Version, add "S" to the part number (e.g. PCG-M25-BS). Flex Styles are not available on the PCG-M32 to PCG-M63 versions.

Longer thread styles are available (15 mm long for M16 - M32 and 18 mm long for M40 - M63). Add an "L" after the part number, but before any "-B" (e.g. PCG-M32RL or PCG-M25L-B)

Material:

Body: Polyamide
Seal: Neoprene

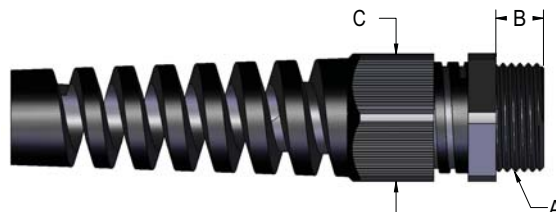



Cable Glands: Metric Threads

Dual Grommet Plastic Cable Glands

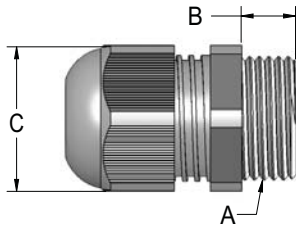

These Cable Glands have a dual grommet system that allows for a much wider range in diameter than the standard plastic cable glands. Cables that are in the lower part of the diameter range will fit into the cable gland without any change. For cables that are in the upper part of the diameter range, the dome nut is removed and the seals are removed. Separate the inner seal from the outer seal into the cable gland and then put the outer seal back in place. It is now ready for use with the larger cable.

A Locking Nut is supplied on all Metric threaded parts. An O-Ring is not needed on any sizes smaller than M32. An O-Ring is supplied on size M32 and larger.

| Part Number | | Diameter Range (mm) | A Mounting Hole Clearance (mm) | B Thread Length (mm) | C Wrench Flats (mm) | Thread Type |
|-------------|------------|---------------------|-----------------------------------|-------------------------|------------------------|-------------|
| Gray | Black | | | | | |
| PCGU-M12 | PCGU-M12-B | 2 - 5 | 12.5 | 8 | 15 | M12 x 1.5 |
| PCGU-M16 | PCGU-M16-B | 3 - 10 | 16.5 | 8 | 20 | M16 x 1.5 |
| PCGU-M20 | PCGU-M20-B | 5 - 13 | 20.5 | 8 | 24 | M20 x 1.5 |
| PCGU-M25 | PCGU-M25-B | 8 - 17 | 25.5 | 8 | 29 | M25 x 1.5 |
| PCGU-M32 | PCGU-M32-B | 12 - 21 | 32.5 | 10 | 36 | M32 x 1.5 |
| PCGU-M40 | PCGU-M40-B | 16 - 28 | 40.5 | 10 | 46 | M40 x 1.5 |
| PCGU-M50 | PCGU-M50-B | 21 - 35 | 50.5 | 12 | 55 | M50 x 1.5 |
| PCGU-M63 | PCGU-M63-B | 27 - 48 | 63.5 | 12 | 68 | M63 x 1.5 |

Material:

Body: Polyamide

O-Ring: BUNA-N

Cable Glands: Metric, PG & NPT Threads

Cable Glands for Flat & Festoon Cable

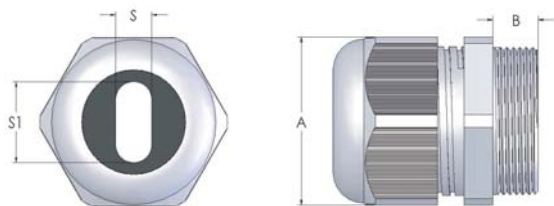

Cable Glands for Flat Cable Applications

Mencom's plastic and brass cable glands are perfect for flat and festoon cables. Sealing ratings up to IP 66 can be obtained.

A Locking Nut is supplied on all Metric and PG threaded parts. An O-Ring is not needed for the plastic style cable glands smaller than M32. O-Rings are supplied on M32 and larger sizes.

| Plastic Version | | | | | | | | | |
|-----------------|------------------|------------------------------|-------------------------------|--------------------------|--------------------------|-------------------------|-------------------------|----------------|---------------------------------------|
| Part Numbers | | A Wrench Flats (mm) | B Thread Length (mm) | S1 DIM MAX (mm) | S1 DIM MIN (mm) | S DIM MAX (mm) | S DIM MIN (mm) | Thread Type | Mounting Hole Clearance (mm) |
| Gray | Black | | | | | | | | |
| PFG-M20-12X5 | PFG-M20-12X5-B | 24 | 8 | 12 | 8 | 5 | 2 | M20 x 1.5 | 20.5 |
| PFG-M25-16.3X6 | PFG-M25-16.3X6-B | 29 | 8 | 16.3 | 10 | 6 | 2 | M25 x 1.5 | 25.5 |
| PFG-M32-20X9 | PFG-M32-20X9-B | 36 | 10 | 20 | 12 | 9 | 3 | M32 x 1.5 | 32.5 |
| PFG-M40-27X10 | PFG-M40-27X10-B | 46 | 10 | 27 | 19 | 10 | 3 | M40 x 1.5 | 40.5 |
| PFG-M50-34X13 | PFG-M50-34X13-B | 55 | 12 | 34 | 23 | 13 | 4 | M50 x 1.5 | 50.5 |
| PFG-M63-45X15 | PFG-M63-45X15-B | 68 | 12 | 45 | 32 | 15 | 6 | M63 x 1.5 | 63.5 |
| PFG-1/2-12X5 | PFG-1/2-12X5-B | 22 | 13 | 12 | 8 | 5 | 2 | 1/2-14 NPT | 21.5 |
| PFG-13.5-12X5 | PFG-13.5-12X5-B | 22 | 6.5 | 12 | 8 | 5 | 2 | PG13.5 | 20.7 |

| Brass Version | | | | | | | | |
|----------------|------------------------------|-------------------------------|--------------------------|--------------------------|-------------------------|-------------------------|---------------|---------------------------------------|
| Part Numbers | A Wrench Flats (mm) | B Thread Length (mm) | S1 DIM MAX (mm) | S1 DIM MIN (mm) | S DIM MAX (mm) | S DIM MIN (mm) | Thread Type | Mounting Hole Clearance (mm) |
| MFG-M20-12X5 | 24 | 6 | 12 | 9 | 5 | 2 | M20 x 1.5 | 20.5 |
| MFG-M25-16.3X6 | 29 | 7 | 16.3 | 11 | 6 | 2 | M25 x 1.5 | 25.5 |
| MFG-M32-20X9 | 36 | 8 | 20 | 13 | 9 | 3 | M32 x 1.5 | 32.5 |
| MFG-M40-27X10 | 46 | 8 | 27 | 17 | 10 | 3 | M40 x 1.5 | 40.5 |
| MFG-M50-34X13 | 55 | 9 | 34 | 24 | 13 | 4 | M50 x 1.5 | 50.5 |
| MFG-M63-45X15 | 68 | 10 | 45 | 33 | 15 | 6 | M63 x 1.5 | 63.5 |
| MFG-1/2-12X5 | 22 | 13 | 12 | 9 | 5 | 2 | 1/2" - 14 NPT | 21.5 |
| MFG-13.5-12X5 | 22 | 6.5 | 12 | 9 | 5 | 2 | PG 13.5 | 20.7 |

Plastic Version Materials:

Body: Polyamide
Grommet: TPE
O-Ring: BUNA-N

Brass Version Materials:

Body: Nickel Plated
Brass
Insert: Polyamide
Grommet: TPE
O-Ring: BUNA-N

Sealing for these cable glands is IP 66 only if the cable matches the slot dimensions exactly. For cables that are less than the "max", but more than the "min", the seals are rated to IP 54. Longer thread lengths are available for some of these cable glands, please consult the factory.



Cable Glands: Metric Threads

EMI Shielding Brass Cable Glands ❖ Metric Threads

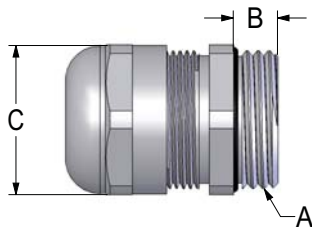

Mencom EMI Cable Glands provide an easy way to ground the shield from a shielded cable to the body of the metal cable gland. The seal rating is IP 68.

Special cutting Locking Nuts can be ordered separately. The Lock Nuts have sharp "teeth" that will cut through painted surfaces, see page V-21.

| Part Number | Diameter Range (mm) | A Mounting Hole Clearance (mm) | B Thread Length (mm) | C Wrench Flats (mm) | Thread Type |
|-------------|---------------------|-----------------------------------|-------------------------|------------------------|-------------|
| MCGB-M12 * | 3 - 6 | 12.5 | 5 | 14 | M12 x 1.5 |
| MCGB-M12L | 3 - 6 | 12.5 | 10 | 14 | M12 x 1.5 |
| MCGB-M16 * | 3 - 9 | 16.5 | 5 | 17 | M16 x 1.5 |
| MCGB-M16L | 3 - 9 | 16.5 | 10 | 17 | M16 x 1.5 |
| MCGB-M20 * | 5 - 13 | 20.5 | 6 | 22 | M20 x 1.5 |
| MCGB-M20L | 5 - 13 | 20.5 | 10 | 22 | M20 x 1.5 |
| MCGB-M25 | 8 - 16 | 25.5 | 7 | 27 | M25 x 1.5 |
| MCGB-M25L | 8 - 16 | 25.5 | 11 | 27 | M25 x 1.5 |
| MCGB-M32 | 12 - 21 | 32.5 | 8 | 34 | M32 x 1.5 |
| MCGB-M32L | 12 - 21 | 32.5 | 13 | 34 | M32 x 1.5 |
| MCGB-M40 | 16 - 27 | 40.5 | 8 | 43 | M40 x 1.5 |
| MCGB-M40L | 16 - 27 | 40.5 | 13 | 43 | M40 x 1.5 |
| MCGB-M50 | 21 - 35 | 50.5 | 9 | 55 | M50 x 1.5 |
| MCGB-M50L | 21 - 35 | 50.5 | 14 | 55 | M50 x 1.5 |
| MCGB-M63 | 27 - 48 | 63.5 | 10 | 65 | M63 x 1.5 |

Lock Nuts are supplied with all cable glands listed other than those with an *. These threads are too short to be used with Lock Nuts.



Materials:

Body: Nickel Plated Brass
 Insert: Polyamide
 Seal: Neoprene

Cable Glands: Metric Threads

Explosion-Proof Brass Cable Glands

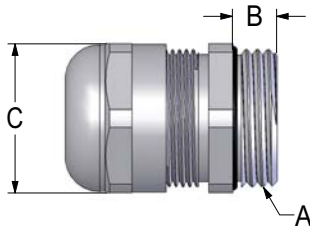

These Explosion-Proof Cable Glands are made of Nickel Plated Brass and are for potentially explosive areas according to EN 50014 and EN 50019. The type of protection is EExd e II-increased safety. There is excellent strain relief, a wide clamping range, and a torsion protected plastic insert that is resistant to impact at cold temperatures. Also, the cable glands feature a neoprene sealing insert, the O-Ring seal is BUNA-N, and the permanent ambient temperature is -25°C to +80°C (-13° F to +176°F). Protection type is IP 68 according to EN 60529, E-Generation, certificate of conformity: DMT 99 ATEX E 016. Locking Nuts must be ordered separately.

| Part Number | Diameter Range (mm) | A Mounting Hole Clearance (mm) | B Thread Length (mm) | C Wrench Flats (mm) | Thread Type |
|-------------|---------------------|--------------------------------|----------------------|---------------------|-------------|
| MCGEX-M12 | 3 - 6.5 | 12.5 | 5 | 14 | M12 x 1.5 |
| MCGEX-M16 | 5 - 9 | 16.5 | 5 | 17 | M16 x 1.5 |
| MCGEX-M20 | 6 - 12 | 20.5 | 6 | 22 | M20 x 1.5 |
| MCGEX-M25 | 11 - 16 | 25.5 | 7 | 27 | M25 x 1.5 |
| MCGEX-M32 | 14 - 21 | 32.5 | 8 | 34 | M32 x 1.5 |
| MCGEX-M40 | 19 - 27 | 40.5 | 8 | 43 | M40 x 1.5 |
| MCGEX-M50 | 24 - 35 | 50.5 | 9 | 55 | M50 x 1.5 |
| MCGEX-M63 | 32 - 42 | 63.5 | 10 | 65 | M63 x 1.5 |

ATEX 100a

With a view toward further harmonization of the legal provisions in the European Union in respect to the use of equipment and protection systems in accordance with the regulations in areas subject to explosion hazards, the European Parliament and Council passed Directive 94/9/EC on the 23rd of March, 1994. This directive is also known as ATEX 100A. The period for implementing this guideline started on the 1st of March, 1996 and from the 1st of July, 2003 onwards, it will replace and supplement all directives on explosion protection applicable to date at the European level. The single market requires national regulations to be replaced by European Standards (EN).

The ATEX 100A governs the requirements for all (both electrical and non-electrical) equipment and protection systems which are intended for use in areas subject to explosion hazards. Monitoring, control and safety equipment for use outside areas subject to explosion hazards also fall within the provisions of this directive if they are necessary in view of explosion hazards for the safe running of equipment and protection systems.

The explosion-proof cable glands listed in this catalog are produced in Germany and are for use in areas subject to explosion hazards. Such parts are also termed "cable glands and entry fittings" (abbreviated KLE) and "accessories."

EN 50014 defines cable glands and entry fittings as equipment which allows one or several electrical and/or fibre optic cables or wires to be inserted into electrical equipment while retaining the corresponding type of protection.

The explosion-proof KLE items contained in this catalog are suitable for inserting cables and wires into housing of protection type EEx e "increased safety," and EEx i "inherent safety" in Device Groups II and Categories 2 and 3.

For further information on ATEX and European explosion-proof classifications, please consult the factory.

These specifications are not intended to be correlated to or to be a substitution for U.S. Explosion-Proof ratings.



Cable Glands: Metric Threads

Explosion-Proof Plastic Cable Glands

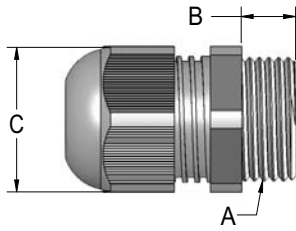

Type of protection EExd e II- increased safety. Permanent ambient temperature -50°C to +55°C (-58°F to +131°F). Protection type is IP 66 according to EN 60529. Certificate of conformity: PTB-No. Ex-92-C.3142; PTB-No. Ex-92.C3108X (M12 & M16).

Locking Nuts must be ordered separately.

| Color | Part Number | Diameter Range (mm) | A Mounting Hole Clearance (mm) | B Thread Length (mm) | C Wrench Flats (mm) | Thread Type |
|-------|--------------|---------------------|--------------------------------|----------------------|---------------------|-------------|
| Black | PCGEX-M12-B | 4 - 7 | 12.5 | 8 | 15 | M12 x 1.5 |
| Black | PCGEX-M12L-B | 4 - 7 | 12.5 | 12 | 15 | M12 x 1.5 |
| Black | PCGEX-M16-B | 5.5 - 10 | 16.5 | 8 | 20 | M16 x 1.5 |
| Black | PCGEX-M16L-B | 5.5 - 10 | 16.5 | 12 | 20 | M16 x 1.5 |
| Black | PCGEX-M20-B | 5.5 - 13 | 20.5 | 8 | 24 | M20 x 1.5 |
| Black | PCGEX-M20L-B | 5.5 - 13 | 20.5 | 13 | 24 | M20 x 1.5 |
| Black | PCGEX-M25-B | 8 - 17 | 25.5 | 8 | 29 | M25 x 1.5 |
| Black | PCGEX-M25L-B | 8 - 17 | 25.5 | 13 | 29 | M25 x 1.5 |
| Black | PCGEX-M32-B | 12 - 21 | 32.5 | 10 | 36 | M32 x 1.5 |
| Black | PCGEX-M40-B | 17 - 28 | 40.5 | 10 | 46 | M40 x 1.5 |
| Black | PCGEX-M50-B | 22 - 35 | 50.5 | 12 | 55 | M50 x 1.5 |
| Black | PCGEX-M63-B | 27 - 48 | 63.5 | 12 | 68 | M63 x 1.5 |

Intrinsically safe explosion proof versions are also available, please consult the factory. Protection type EExd e II is a standard European classification.

Materials: ALCRYM

These specifications are NOT intended to be correlated to or to be a substitution for U.S. Explosion-Proof ratings.

Cable Glands: Metric Threads

Nuts & Plugs



| Nuts | | | | | | | | |
|--------------|---------------|-------|----------|---------|--------|--------|--------|-------------|
| Part Number | | | | Plastic | | Metal | | Thread Type |
| Gray Plastic | Black Plastic | Metal | Cutting | A (mm) | B (mm) | A (mm) | B (mm) | |
| 2M12PA | 2M12PA/SW | 2M12M | 2M12MPOT | 17 | 5 | 15 | 2.8 | M12 x 1.5 |
| 2M16PA | 2M16PA/SW | 2M16M | 2M16MPOT | 22 | 5 | 19 | 2.8 | M16 x 1.5 |
| 2M20PA | 2M20PA/SW | 2M20M | 2M20MPOT | 27 | 6 | 24 | 3 | M20 x 1.5 |
| 2M25PA | 2M25PA/SW | 2M25M | 2M25MPOT | 32 | 6 | 30 | 3.5 | M25 x 1.5 |
| 2M32PA | 2M32PA/SW | 2M32M | 2M32MPOT | 41 | 7 | 36 | 4 | M32 x 1.5 |
| 2M40PA | 2M40PA/SW | 2M40M | 2M40MPOT | 50 | 7 | 46 | 5 | M40 x 1.5 |
| 2M50PA | 2M50PA/SW | 2M50M | 2M50MPOT | 60 | 8 | 60 | 5 | M50 x 1.5 |
| 2M63PA | 2M63PA/SW | 2M63M | 2M63MPOT | 75 | 8 | 70 | 6 | M63 x 1.5 |

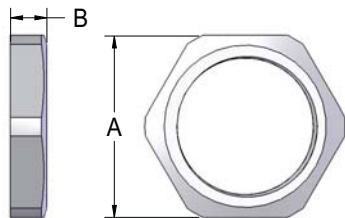

Material:
 Plastic: Polyamide
 Metal: Nickel Plated Brass
 O-Ring: BUNA-N

| Blanking Plugs | | | | | | | |
|----------------|---------------|---------|---------------|--------------------|---------------|--------------------|-------------|
| Part Number | | | Plastic | | Metal | | Thread Type |
| Gray Plastic | Black Plastic | Metal | Diameter (mm) | Thread Length (mm) | Diameter (mm) | Thread Length (mm) | |
| CRB-M12PA | CRB-M12PA/SW | CRB-M12 | 15 | 6 | 16 | 5 | M12 x 1.5 |
| CRB-M16PA | CRB-M16PA/SW | CRB-M16 | 20 | 6 | 20 | 6 | M16 x 1.5 |
| CRB-M20PA | CRB-M20PA/SW | CRB-M20 | 24 | 6 | 24 | 6.5 | M20 x 1.5 |
| CRB-M25PA | CRB-M25PA/SW | CRB-M25 | 30 | 8 | 28 | 7 | M25 x 1.5 |
| CRB-M32PA | CRB-M32PA/SW | CRB-M32 | 37 | 8 | 35 | 8 | M32 x 1.5 |
| CRB-M40PA | CRB-M40PA/SW | CRB-M40 | 46 | 8 | 45 | 8 | M40 x 1.5 |
| CRB-M50PA | CRB-M50PA/SW | CRB-M50 | 56 | 10 | 55 | 9 | M50 x 1.5 |
| CRB-M63PA | CRB-M63PA/SW | CRB-M63 | 70 | 12 | 68 | 10 | M63 x 1.5 |

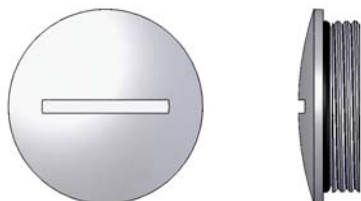

Material:
 Plastic: Polyamide
 Metal: Nickel Plated Brass
 O-Ring: BUNA-N

Cable Glands & Adapters



Cable Glands: Metric Threads

Adapters

| Metric to PG | | | | | | |
|--------------|-----------|-------|--------|--------|--------|--------|
| Part Number | A | B | C (mm) | D (mm) | E (mm) | F (mm) |
| M12-PG9 | M12 x 1.5 | PG 09 | 11 | 5 | 8 | 17 |
| M16-PG11 | M16 x 1.5 | PG 11 | 11.5 | 5 | 12 | 20 |
| M20-PG16 | M20 x 1.5 | PG 16 | 13.5 | 6 | 15 | 24 |
| M25-PG21 | M25 x 1.5 | PG 21 | 14.5 | 7 | 21 | 30 |
| M32-PG29 | M32 x 1.5 | PG 29 | 17 | 8 | 26 | 39 |
| M40-PG36 | M40 x 1.5 | PG 36 | 20.5 | 8 | 34 | 50 |
| M50-PG42 | M50 x 1.5 | PG 42 | 23 | 9 | 44 | 57 |
| M50-PG48 | M50 x 1.5 | PG 48 | 24 | 9 | 44 | 64 |

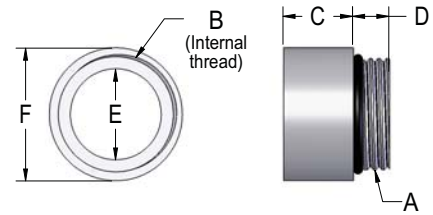

Material:

Body: Nickel Plated Brass
O-Ring: BUNA-N

| Metric to NPT (Metal) | | | | | | |
|-----------------------|-----------|-----------|--------|--------|--------|--------|
| Part Number | A | B | C (mm) | D (mm) | E (mm) | F (mm) |
| M16-1/2 | M16 x 1.5 | 1/2" NPT | 18.5 | 6.5 | 11 | 24 |
| M20-1/2 | M20 x 1.5 | 1/2" NPT | 18.5 | 6.5 | 15 | 24 |
| M25-3/4 | M25 x 1.5 | 3/4" NPT | 21 | 7 | 18 | 30 |
| M32-3/4 | M32 x 1.5 | 3/4" NPT | 18 | 8 | 23 | 37 |
| M32-1 | M32 x 1.5 | 1" NPT | 25 | 8 | 27 | 38 |
| M40-1.25 | M40 x 1.5 | 1.25" NPT | 26 | 8 | 34 | 46 |

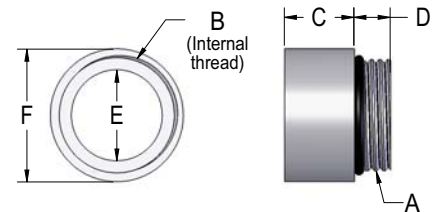

Material:

Body: Nickel Plated Brass
O-Ring: BUNA-N

| Metric to NPT (Black Plastic) | | | | | | |
|-------------------------------|-----------|----------|--------|--------|--------|--------|
| Part Number | A | B | C (mm) | D (mm) | E (mm) | F (mm) |
| M16-1/2PA/SW | M16 x 1.5 | 1/2" NPT | 27 | 8 | 28 | 11 |
| M20-1/2PA/SW | M20 x 1.5 | 1/2" NPT | 27 | 8 | 27 | 15 |

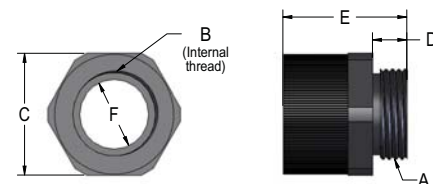

Material:

Body: Polyamide

Cable Glands & Adapters

Cable Glands: Metric Threads

Reducers & Enlargers

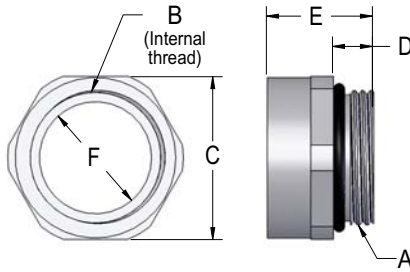

Material:

Body: Nickel Plated Brass
O-Ring: BUNA-N

| Metric Enlargers | | | | | | |
|------------------|-----------|-----------|--------|--------|--------|--------|
| Part Number | A | B | C (mm) | D (mm) | E (mm) | F (mm) |
| CRC-M12 | M12 x 1.5 | M16 x 1.5 | 18 | 5 | 16 | 8 |
| CRC-M16 | M16 x 1.5 | M20 x 1.5 | 22 | 5 | 16.5 | 12 |
| CRC-M20 | M20 x 1.5 | M25 x 1.5 | 27 | 6 | 18.5 | 15 |
| CRC-M25 | M25 x 1.5 | M32 x 1.5 | 34 | 7 | 20.5 | 21 |
| CRC-M32 | M32 x 1.5 | M40 x 1.5 | 42 | 8 | 23.5 | 26 |
| CRC-M40 | M40 x 1.5 | M50 x 1.5 | 52 | 8 | 30 | 34 |
| CRC-M50 | M50 x 1.5 | M63 x 1.5 | 65 | 9 | 32.5 | 44 |

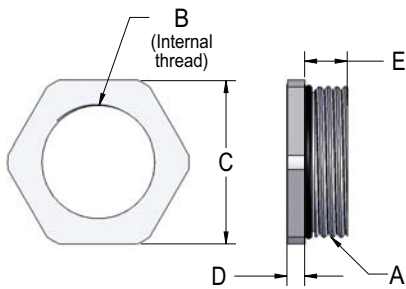

Material:

Body: Nickel Plated Brass
O-Ring: BUNA-N

| Metric Reducers | | | | | |
|-----------------|-----------|-----------|--------|--------|--------|
| Part Number | A | B | C (mm) | D (mm) | E (mm) |
| CEC-M12 | M16 x 1.5 | M12 x 1.5 | 17 | 5 | 8 |
| CEC-M12X | M20 x 1.5 | M12 x 1.5 | 22 | 6 | 9 |
| CEC-M16 | M20 x 1.5 | M16 x 1.5 | 22 | 6 | 9 |
| CEC-M16X | M25 x 1.5 | M16 x 1.5 | 27 | 7 | 10 |
| CEC-M20 | M25 x 1.5 | M20 x 1.5 | 27 | 7 | 10 |
| CEC-M20X | M32 x 1.5 | M20 x 1.5 | 34 | 8 | 11 |
| CEC-M25 | M32 x 1.5 | M25 x 1.5 | 34 | 8 | 11 |
| CEC-M20Y | M40 x 1.5 | M20 x 1.5 | 43 | 8 | 12 |
| CEC-M25X | M40 x 1.5 | M25 x 1.5 | 43 | 8 | 12 |
| CEC-M32 | M40 x 1.5 | M32 x 1.5 | 43 | 8 | 12 |
| CEC-M25Y | M50 x 1.5 | M25 x 1.5 | 55 | 9 | 13 |
| CEC-M32X | M50 x 1.5 | M32 x 1.5 | 55 | 9 | 13 |
| CEC-M40 | M50 x 1.5 | M40 x 1.5 | 55 | 9 | 13 |
| CEC-M32Y | M63 x 1.5 | M32 x 1.5 | 65 | 10 | 14 |
| CEC-M40X | M63 x 1.5 | M40 x 1.5 | 65 | 10 | 14 |
| CEC-M50 | M63 x 1.5 | M50 x 1.5 | 65 | 10 | 14 |



Cable Glands: PG Threads

Multi-Hole Cable Gland Inserts ❖ PG 9 - PG 13.5 Cable Gland Accessories

Mencom Multi-Hole Cable Gland Inserts will allow the user to use one cable gland for multiple wires, cables, or tubes. The inserts fit into the Mencom "MCG" or "PCG" cable glands, and will seal to IP 65.

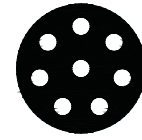

| Part Number | # of Holes | Diameter of Holes mm (inches) | Fits Into | |
|--------------|------------|----------------------------------|------------|-------------|
| PG09-0x0 | 0 | None | | |
| PG09-2x3 | 2 | 3 (0.118) | | |
| PG09-2x3.5 | 2 | 3.5 (0.138) | MCG-09 | PCG-09 |
| PG09-3x2 | 3 | 2 (0.079) | MCG-09R | PCG-09-B |
| PG09-3x3.5 | 3 | 3.5 (0.138) | MCG-3/8 | PCG-09R |
| PG09-4x2 | 4 | 2 (0.079) | MCG-3/8R | PCG-09R-B |
| PG09-4x3 | 4 | 3 (0.118) | | |
| PG11-0x0 | 0 | None | | |
| PG11-2x3 | 2 | 3 (0.118) | | |
| PG11-2x4 | 2 | 4 (0.157) | MCG-11 | PCG-3/8-B |
| PG11-2x4.5 | 2 | 4.5 (0.177) | MCG-11R | PCG-3/8R |
| PG11-2x5 | 2 | 5 (0.197) | PCG-11 | PCG-3/8R-B |
| PG11-3x3 | 3 | 3 (0.118) | PCG-11-B | PCG-M16 |
| PG11-3x4 | 3 | 4 (0.157) | PCG-11R | PCG-M16-B |
| PG11-3x5 | 3 | 5 (0.197) | PCG-11R-B | PCG-M16R |
| PG11-4x3 | 4 | 3 (0.118) | PCG-3/8 | PCG-M16R-B |
| PG11-7x2.7 | 7 | 2.7 (0.107) | | |
| PG11-8x2 | 8 | 2 (0.079) | | |
| PG13.5-0x0 | 0 | None | MCG-13.5 | PCG-13.5R-B |
| PG13.5-2x4.5 | 2 | 4.5 (0.177) | MCG-13.5R | PCG-1/2X |
| PG13.5-2x5 | 2 | 5 (0.197) | MCG-1/2 | PCG-1/2X-B |
| PG13.5-2x6 | 2 | 6 (0.236) | MCG-1/2R | PCB-1/2Y |
| PG13-3x4 | 3 | 4 (0.157) | PCG-13.5 | PCG-1/2Y-B |
| PG13-3x5 | 3 | 5 (0.197) | PCG-13.5-B | PCG-M20R |
| | | | PCG-13.5R | PCG-M20R-B |
| PG16-0x0 | 0 | None | | |
| PG16-2x4 | 2 | 4 (0.157) | | |
| PG16-2x6 | 2 | 6 (0.236) | | |
| PG16-3x4 | 3 | 4 (0.157) | MCG-16 | PCG-1/2 |
| PG16-3x4.5 | 3 | 4.5 (0.177) | MCG-16R | PCG-1/2-B |
| PG16-3x5 | 3 | 5 (0.197) | PCG-16 | PCG-1/2R |
| PG16-3x6 | 3 | 6 (0.236) | PCG-16-B | PCG-1/2R-B |
| PG16-3x6.5 | 3 | 6.5 (0.256) | PCG-16R | PCG-M20 |
| PG16-3x7 | 3 | 7 (0.276) | PCG-16R-B | PCG-M20B |
| PG16-4x4 | 4 | 4 (0.157) | | |
| PG16-4x5 | 4 | 5 (0.197) | | |
| PG16-4x6 | 4 | 6 (0.236) | | |
| PG16-5x4 | 5 | 4 (0.157) | | |

Inserts are intended for use with wires, cables, or tubes that have diameters that are within ± 0.020 " of the "hole diameter" listed.

Inserts without holes allow the user to drill holes for low volume, custom applications.

Cable Glands: PG Threads

Multi-Hole Cable Gland Inserts ❖ PG 16 - PG 29 Cable Gland Accessories



Mencom Multi-Hole Cable Gland Inserts will allow the user to use one cable gland for multiple wires, cables, or tubes. The inserts fit into the Mencom "MCG" or "PCG" cable glands, and will seal to IP 65.

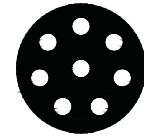

| Part Number | # of Holes | Diameter of Holes mm (inches) | Fits Into | | |
|-------------|------------|----------------------------------|--|--|--|
| PG21-0x0 | 0 | None | MCG-21 MCG-21R PCG-21-B PCG-21R PCG-21R-B PCG-3/4 PCG-3/4-B PCG-3/4-R PCG-3/4R-B PCG-M25 PCG-M25-B PCG-M25R PCG-M25R-B | | |
| PG21-2x7 | 2 | 7 (0.276) | | | |
| PG21-2x8 | 2 | 8 (0.315) | | | |
| PG21-2x9 | 2 | 9 (0.354) | | | |
| PG21-3x7 | 3 | 7 (0.276) | | | |
| PG21-3x8 | 3 | 8 (0.315) | | | |
| PG21-4x5 | 4 | 5 (0.197) | | | |
| PG21-4x6.5 | 4 | 6.5 (0.256) | | | |
| PG21-4x7 | 4 | 7 (0.276) | | | |
| PG21-4x7.5 | 4 | 7.5 (0.295) | | | |
| PG21-5x5 | 5 | 5 (0.197) | | | |
| PG29-0x0 | 0 | None | | | |
| PG29-5x8.5 | 5 | 8.5 (0.335) | | | |
| PG29-6x5 | 6 | 5 (0.197) | | | |
| PG29-6x7.5 | 6 | 7.5 (0.295) | | | |
| PG29-8x5 | 8 | 5 (0.197) | | | |
| M25-0x0 | 0 | None | MCG-3/4 MCG-3/4R MCG-M25 | | |
| M25-2x8 | 2 | 8 (0.315) | | | |
| M25-3x4 | 3 | 4 (0.157) | | | |
| M25-3x7 | 3 | 7 (0.107) | | | |
| M25-4x5 | 4 | 5 (0.197) | | | |
| M25-4x6.5 | 4 | 6.5 (0.256) | | | |
| M25-6x6 | 6 | 6 (0.236) | | | |

Inserts can be pre-installed in cable glands for orders of 100 or more. Order as follows:

Multi-Hole Insert
PG 11-3X3

Desired Cable Gland
MCG-11

Resulting Part Number
MCG-11-3X3



Cable Glands: NPT, PG & Metric

ASI Cable Glands & O-Rings ❖ Cable Glands & Accessories

| Part Number | | Figure Number | A Mounting Hole Clearance | B Thread Length | C Wrench Flats | Thread Type |
|---------------------------------|-----------------|---------------|---------------------------------|--------------------|-------------------|-------------|
| Gray | Black | | | | | |
| Plastic ASI Cable Glands | | | | | | |
| PCG-1/2-ASI | PCG-1/2-B-ASI | Figure 1 | .825" | .591" | 1.06" | 1/2" NPT |
| PCG-1/2-2ASI | PCG-1/2-B-2ASI | Figure 2 | .825" | .591" | 1.06" | 1/2" NPT |
| PCG-13.5-ASI | PCG-13.5-B-ASI | Figure 1 | .825" | .354" | .945" | PG 13.5 |
| PCG-13.5-2ASI | PCG-13.5-B-2ASI | Figure 2 | .825" | .354" | .945" | PG 13.5 |
| PCG-M20-ASI | PCG-M20-B-ASI | Figure 1 | 20.5 mm | 8 mm | 27 mm | M20x1.5 |
| PCG-M20-2ASI | PCG-M20-B-2ASI | Figure 2 | 20.5 mm | 8 mm | 27 mm | M20x1.5 |
| PCG-M25-ASI | PCG-M25-B-ASI | Figure 1 | 25.5 mm | 8 mm | 33 mm | M25x1.5 |
| PCG-M25-2ASI | PCG-M25-B-2ASI | Figure 2 | 25.5 mm | 8 mm | 33 mm | M25x1.5 |
| Metal ASI Cable Glands | | | | | | |
| MCG-1/2-ASI | | Figure 1 | .825" | .591" | 1.06" | 1/2" NPT |
| MCG-13.5-ASI | | Figure 1 | .825" | .256" | .945" | PG 13.5 |
| MCG-M20-ASI | | Figure 1 | 20.5 mm | 6 mm | 22 mm | M20x1.5 |
| MCG-M25-ASI | | Figure 1 | 25.5 mm | 7 mm | 27 mm | M25x1.5 |
| MCG-M25-2ASI | | Figure 2 | 25.5 mm | 7 mm | 27 mm | M25x1.5 |

Figure 1: Single

Plastic Material:

Body: Polyamide
Seal: Neoprene

Metal Material:

Body: Nickel Plated Brass
Insert: Polyamide
Seal: Neoprene

Figure 2: Double

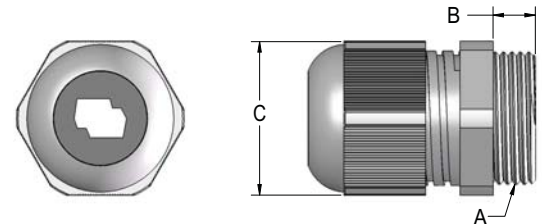
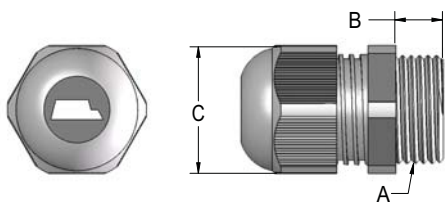

| For Metric Threads: O-Rings (100 Pieces/Package) | | | | |
|--|------|--------|--------|--------|
| Part Number | Size | A (mm) | B (mm) | C (mm) |
| 3M12G | M12 | 12 | 9 | 1.5 |
| 309G | M16 | 16 | 13 | 1.5 |
| 313G | M20 | 21 | 18 | 2.0 |
| 3M25G | M25 | 27 | 23 | 2.0 |
| 3M32G | M32 | 34 | 29 | 2.5 |
| 3M40G | M40 | 41 | 37 | 2.0 |
| 3M50G | M50 | 52 | 47 | 2.5 |
| 3M63G | M63 | 66 | 60 | 3.0 |

Material:

O-Ring: BUNA-N

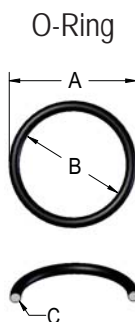

| For PG Threads: O-Rings (100 Pieces/Package) | | | | |
|--|---------|--------|--------|--------|
| Part Number | Size | A (mm) | B (mm) | C (mm) |
| 307G | PG 07 | 13 | 10 | 1.5 |
| 309G | PG 09 | 17 | 13 | 1.5 |
| 311G | PG 11 | 20 | 16 | 2.0 |
| 313G | PG 13.5 | 22 | 18 | 2.0 |
| 316G | PG 16 | 24 | 20 | 2.0 |
| 321G | PG 21 | 28 | 24 | 2.0 |
| 329G | PG 29 | 37 | 33 | 2.0 |
| 336G | PG 36 | 47 | 42 | 2.5 |
| 342G | PG 42 | 53 | 48 | 2.5 |
| 348G | PG 48 | 60 | 54 | 3.0 |

Sealing Glands: Click Seal

Click Seal ❖ TSS



| Click Seal Metric | | | | | | | | | | |
|-------------------|-------------|------|---------------------------|---------------------------|--------------------------------|------------------------------|---------|---------|---------|-------------|
| Color | Part Number | Size | IP 67 Diameter Range (mm) | IP 65 Diameter Range (mm) | A Mounting Hole Clearance (mm) | B Panel Thickness Range (mm) | L1 (mm) | L2 (mm) | L3 (mm) | SW (mm) |
| Gray | SGL-M20-TGY | M20 | 7 - 11 | 4 - 11 | 20.5 | 2 - 5 | 17 - 20 | 5.7 | 4.0 | 29.3 - 34.5 |
| Gray | SGL-M25-TGY | M25 | 7 - 13 | 4 - 14 | 25.5 | 2 - 5 | 17 - 20 | 5.7 | 5.0 | 34.3 - 40.0 |

For volume use, black or light gray glands are available. Please consult the factory for part numbers and availability.

Materials:

Body: TPE (Thermoplastic Elastomer) and Polyamide
 Temperature: -20°C to +125°C (-4° to +257°F)
 Protection: IP67 and IP65

Test standard EN60529:1991+A1, EN50262:1998, EMKO-TUI (03-SEC) FI001/84
 The IP67 cable range has been tested to the same EN 50262 pull force requirements as Mencom's standard PCG cable glands.

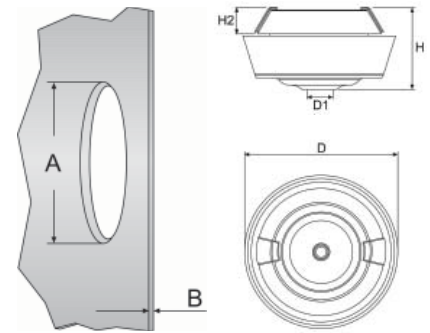

Height of only 17-20 mm, 5.7 mm on the outside irrespective of size. Cable glands are approx. 30-40 mm.

Handles large range of cable and pipe diameters.

Installation time saving up to 90%.

Ergonomic installation

Fixed in both directions when mounted.

Rubber coated tension relief for protection of the cable mantle.

Integrated tension relief

"Pushout" membrane

Self-adjusting to wall thickness 2 - 5 mm.

Space saving design

Fixed IP67 / IP65

Click Seal means no material compression during installation.

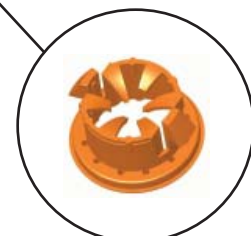

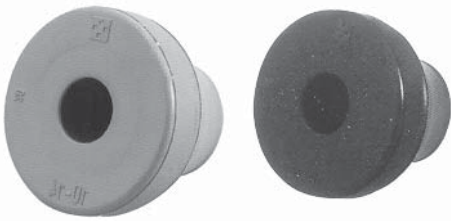

Sealing Glands: PG

EPDM ❖ Chloroprene

| EPDM Sealing Glands for PG Holes | | | | | | | | |
|----------------------------------|-------------|-------|---------------------|--------------------------------|------------------------------|---------|--------|---------|
| Color | Part Number | Size | Diameter Range (mm) | A Mounting Hole Clearance (mm) | B Panel Thickness Range (mm) | Da (mm) | H (mm) | H1 (mm) |
| Gray | SG-PG07-EGY | PG 7 | 3 - 5 | 13 | 0.5 - 2 | 20 | 12.6 | 5.4 |
| Gray | SG-PG09-EGY | PG 9 | 5 - 7 | 16 | 1 - 4 | 21 | 17.8 | 10.3 |
| Gray | SG-PG11-EGY | PG 11 | 7 - 10 | 19 | 1 - 4 | 24 | 19.8 | 12.7 |
| Gray | SG-PG16-EGY | PG 16 | 10 - 14 | 23 | 1 - 4 | 28 | 21.6 | 14.7 |
| Gray | SG-PG21-EGY | PG 21 | 14 - 20 | 29 | 1 - 4 | 35 | 24.6 | 17.6 |
| Gray | SG-PG29-EGY | PG 29 | 20 - 26 | 38 | 1 - 4 | 46 | 28.5 | 20.0 |
| Gray | SG-PG36-EGY | PG 36 | 26 - 35 | 48 | 1 - 4 | 58 | 34.9 | 23.9 |

For volume use, black or light gray glands are available. Please consult the factory for part numbers and availability.

Materials:

Body: EPDM
 Temperature: -40°C to +110°C (-40° to +230°F)
 Protection: IP67

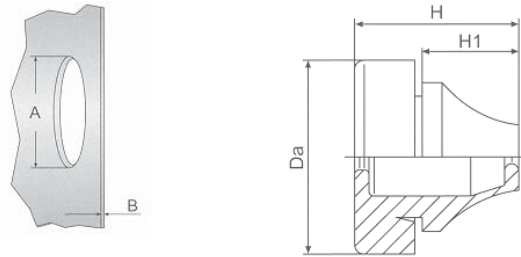

| Chloroprene Sealing Glands for PG Holes | | | | | | | | |
|---|-------------|-------|---------------------|--------------------------------|------------------------------|---------|--------|---------|
| Color | Part Number | Size | Diameter Range (mm) | A Mounting Hole Clearance (mm) | B Panel Thickness Range (mm) | Da (mm) | H (mm) | H1 (mm) |
| Black | SG-PG07-CBK | PG 7 | 3 - 5 | 13 | 0.5 - 2 | 20 | 12.6 | 5.4 |
| Black | SG-PG09-CBK | PG 9 | 5 - 7 | 16 | 1 - 4 | 21 | 17.8 | 10.3 |
| Black | SG-PG11-CBK | PG 11 | 7 - 10 | 19 | 1 - 4 | 24 | 19.8 | 12.7 |
| Black | SG-PG16-CBK | PG 16 | 10 - 14 | 23 | 1 - 4 | 28 | 21.6 | 14.7 |
| Black | SG-PG21-CBK | PG 21 | 14 - 20 | 29 | 1 - 4 | 35 | 24.6 | 17.6 |
| Black | SG-PG29-CBK | PG 29 | 20 - 26 | 38 | 1 - 4 | 46 | 28.5 | 20.0 |
| Black | SG-PG36-CBK | PG 36 | 26 - 35 | 48 | 1 - 4 | 58 | 34.9 | 23.9 |

Materials:

Body: Chloroprene
 Temperature: -30°C to +100°C (-22° to +212°F)
 Protection: IP67

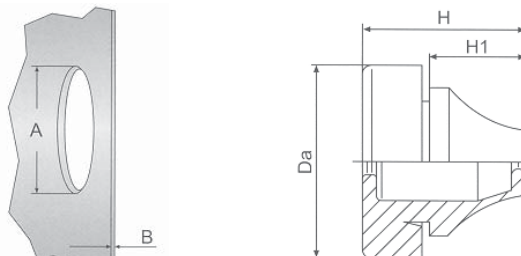

Cable Glands & Adapters

Sealing Glands: Metric

EPDM ❖ Chloroprene ❖ TSS



| EPDM or Chloroprene Sealing Glands for Metric Holes | | | | | | | | | | |
|---|------------------|-------|-------------------------|------|---------------------|--------------------------------|------------------------------|---------|--------|---------|
| Color | EPDM Part Number | Color | Chloroprene Part Number | Size | Diameter Range (mm) | A Mounting Hole Clearance (mm) | B Panel Thickness Range (mm) | Da (mm) | H (mm) | H1 (mm) |
| Gray | SG-M12-EGY | Black | SG-M12-CBK | M12 | 4 - 7 | 12.5 | 0.5 - 2 | 20 | 12.8 | 5.6 |
| Gray | SG-M16-EGY | Black | SG-M16-CBK | M16 | 5 - 9 | 16.5 | 1 - 4 | 21 | 17.7 | 11.0 |
| Gray | SG-M20-EGY | Black | SG-M20-CBK | M20 | 8 - 13 | 20.5 | 1 - 4 | 25.5 | 20.0 | 13.4 |
| Gray | SG-M25-EGY | Black | SG-M25-CBK | M25 | 11 - 17 | 25.5 | 1 - 4 | 30.5 | 21.3 | 15.3 |
| Gray | SG-M32-EGY | Black | SG-M32-CBK | M32 | 15 - 20 | 32.5 | 1 - 4 | 38.5 | 24.6 | 18.6 |
| Gray | SG-M40-EGY | Black | SG-M40-CBK | M40 | 19 - 28 | 40.5 | 1 - 4 | 48.5 | 29.5 | 21.7 |
| Gray | SG-M50-EGY | Black | SG-M50-CBK | M50 | 27 - 35 | 50.5 | 1 - 4 | 60.5 | 34.8 | 25.0 |

For volume use, black or white glands are available. Please consult the factory for part numbers and availability.

Materials:

Body: EPDM
 Temperature: -40°C to +110°C (-40° to +230°F)
 Protection: IP67

Materials:

Body: Chloroprene
 Temperature: -30°C to +100°C (-22° to +212°F)
 Protection: IP67

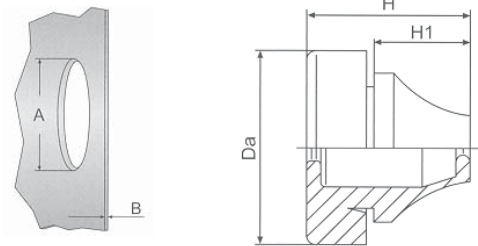

| TSS Metric | | | | | | | | | | |
|------------|-------------|------|---------------------|--------------------------------|------------------------------|--------|---------|---------|--------|---------|
| Color | Part Number | Size | Diameter Range (mm) | A Mounting Hole Clearance (mm) | B Panel Thickness Range (mm) | H (mm) | H1 (mm) | H2 (mm) | D (mm) | D1 (mm) |
| Gray | SGC-M16-TGY | M16 | 5 - 10 | 16.5 | 0.5 - 3.0 | 11 | 4 | 6.75 | 23.5 | 4 |
| Gray | SGC-M20-TGY | M20 | 6 - 13 | 20.5 | 0.5 - 3.0 | 11 | 4 | 6.75 | 27.5 | 5 |
| Gray | SGC-M25-TGY | M25 | 8 - 17 | 25.5 | 0.5 - 3.5 | 11 | 4 | 6.75 | 32.5 | 7 |
| Gray | SGC-M32-TGY | M32 | 12 - 24 | 32.5 | 0.5 - 4.5 | 11 | 4 | 6.75 | 39.5 | 11 |

Materials:

Body: TPE (Thermoplastic Elastomer)
 Temperature: -50°C to +125°C (-58° to +257°F)
 Protection: IP67

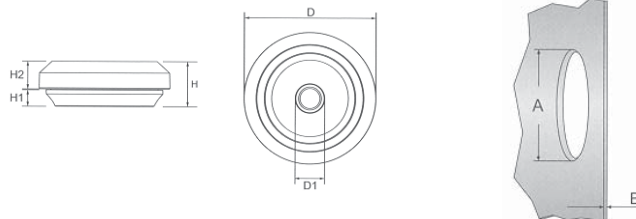



Cable Entry System

Frames



This unique and versatile cable entry system allows for custom designed solutions based on individual applications. Simply put the inserts together, place them in the frame, and install on your panel. Whether you have two large cables, or fifty small cables, or any combination between the two, this flexible frame and insert design can provide what you need.

Fiberglass reinforced Polypropylene is used for the frame and the inserts, ensuring a rigid and reliable structure. The soft TPE insert membrane allows for the ease of a push-out design with exceptional sealing properties.

With this cable entry system you have the freedom to decide where the inserts are placed, and where the different size openings should be in the frame. You will get a sealing solution that is easy to install, that allows for growth, and still maintains an IP65 protection rating.



No tools are needed to install cables once the frame has been mounted. The inserts have push-out membranes that insure a proper seal every time. If additional strain relief is desired, the membranes can be removed and a standard cable gland can be mounted in the resulting hole.

| Part Number | Description | View |
|-------------|---|------|
| FL21-FRAME | <p>Large frame for flexible cable entry system</p> <p>Frame will accept a maximum of five 34mm wide inserts. Total insert length not to exceed 170mm.</p> <p>Frame will accept combinations of insert with the part numbers FLI-44-001, FLI-44-002, FLI-42-001, FLI-42-002, & FLI-42-003.</p> | |
| FL13-FRAME | <p>Small frame for flexible cable entry system</p> <p>Frame will accept a maximum of three 34mm wide inserts. Total insert length not to exceed 102mm.</p> <p>Frame will accept combinations of inserts with the part numbers FLI-42-001, FLI-42-002, FLI-42-0003 & FLI-22-001.</p> | |

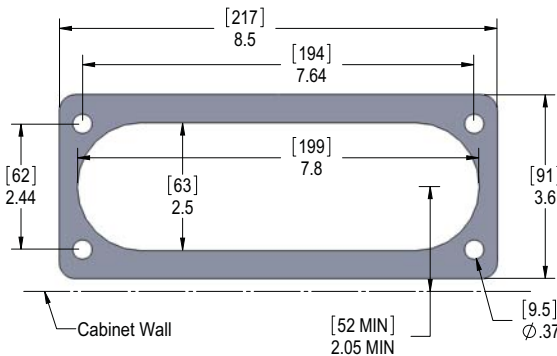

FL21-Frame

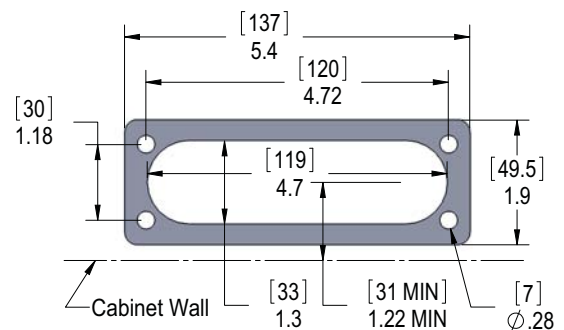

FL13-Frame

Cable Entry System

Inserts



| Part Number | Description | View |
|-------------|--|------|
| FLI-44-001 | Cable entry system insert, 2xM16 and 2xM25, 68 mm x 68 mm | |
| FLI-44-002 | Cable entry system insert, Knock-out for M32, M40, or M50, 68 mm x 68 mm | |
| FLI-42-001 | Cable entry system insert, 2xM20, 68 mm x 34 mm | |
| FLI-42-002 | Cable entry system insert, 2xM25, 68 mm x 34 mm | |
| FLI-42-003 | Cable entry system insert, 10x4 mm, 68 mm x 34 mm | |
| FLI-22-001 | Cable entry system insert 1xM20, 34 mm x 34 mm | |

Specifications:

Material: Fiberglass reinforced Polypropylene and TPE
 UL approved halogen-free material
 Protection: IP65
 Temperature: -20°C.....+125°C

| Cable Opening Size | Cable Range |
|--------------------|-------------|
| M16 | 5 - 10 mm |
| M20 | 6 - 13 mm |
| M25 | 8 - 17 mm |
| 4-10 | 4 - 10 mm |

Cable Glands & Adapters

